

Spring 2013

Schedule of Classes

New Mexico State University Grants



Upper level

Upper Level Entrance

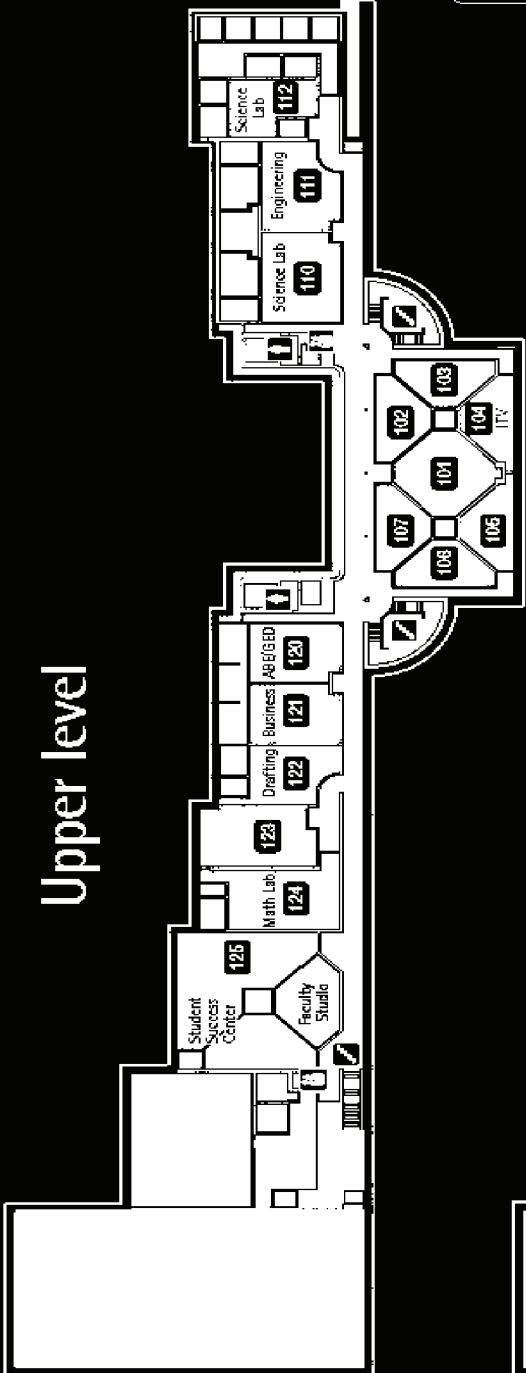

Lower level

SW Entrance

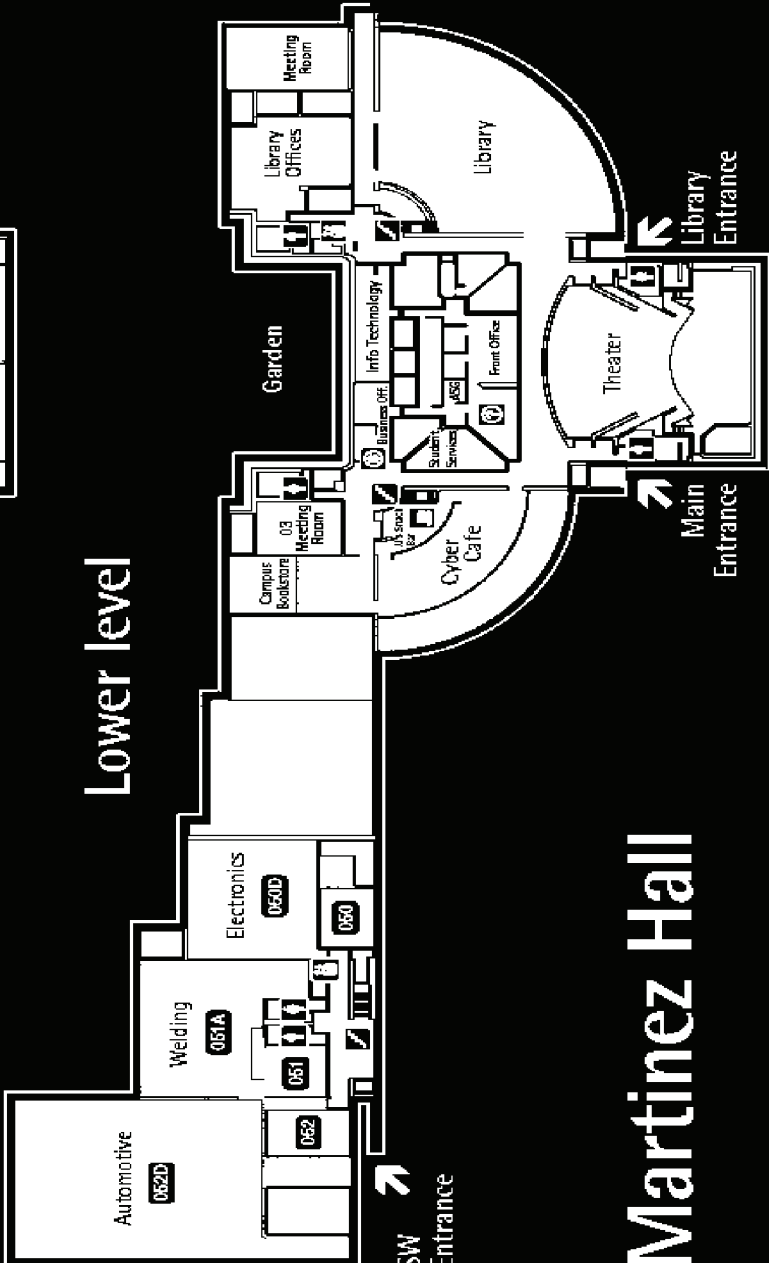

Martinez Hall

Legend

- Classrooms
- Faculty offices
- Administrative offices
- Hallways
- Stairs
- Restrooms
- Business Office
- Front Office

NMSU Grants

- Fidel
- Martinez
- McClure
- See all Martinez Grants

Upper level

Lower level

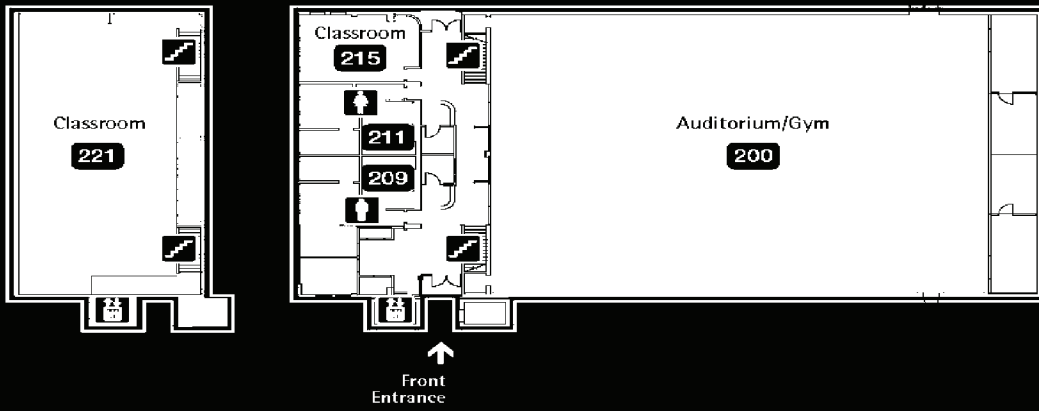

Legend

- Classrooms
- Faculty offices
- Hallway
- Restrooms/Lockerrooms



Fidel Building

Main Entrance

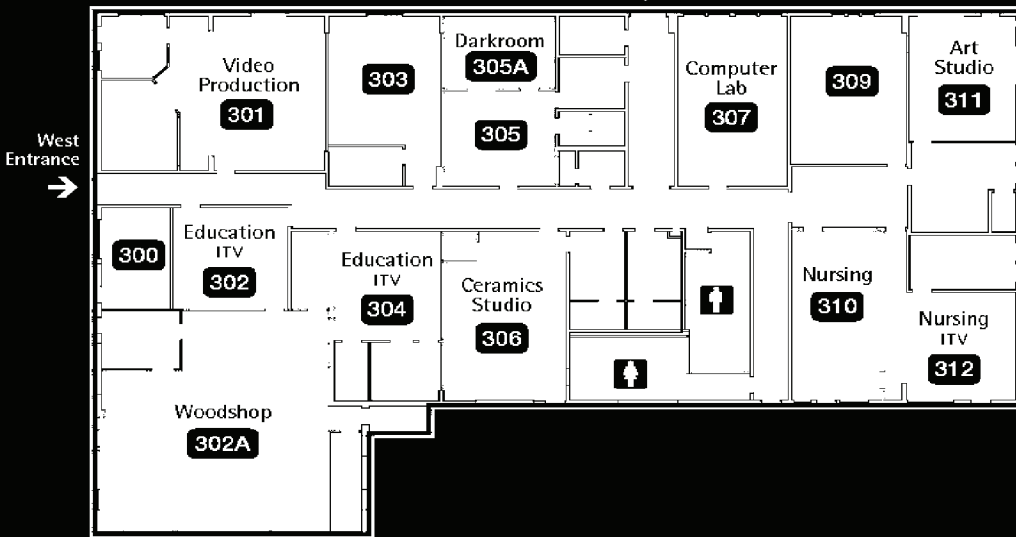

Legend

- Classrooms
- Faculty offices
- Hallway
- Restrooms

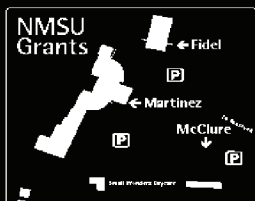

McClure Building

Table of Contents

Admissions/Financial Aid	13
Barnes & Noble Hours.....	7
Calendar.....	6
Campus Map.....	2-3
Campus Programs/Policies	12
Costs	8
Distance Education/BSN Program.....	14
Instructional Support Services	11
Online Registration.....	5
Refunds.....	10
Registration Checklist.....	5
Registration Schedule by classification	4
Release forms.....	14-15
Schedule of Classes	16
Service Hours.....	7
Small Business Development Center.....	11
Student Confidentiality Form	14
Terms & Conditions of Registration.....	9-10
Whom to see	4

Registration Schedule by Classification

- Crimson Scholars (Seniors and Juniors)--- Nov. 08
- Crimson Scholars (Sophomores and Freshman)----- Nov. 09
- Disabled Students (students with disabilities must have approval from Services for Students with Disabilities Program)----- Nov. 08
- Graduate Students ----- Nov. 12
- Senior Citizens ----- Nov. 12
- Seniors (94 earned credits or more) ----- Nov. 12
- Juniors (62-93 earned credits)----- Nov. 13
- Sophomores (28-61 earned credits) ----- Nov. 14
- Freshman (0-27 earned credits)----- Nov. 15
- Non-Degree Students----- Nov. 16
- Readmitted Students (last attended prior to Spring 2013)----- Nov. 16
- New Transfer Students----- Nov. 26
- New Students (Undergraduate and Graduate Students) ----- Nov. 26
- New International Graduate Students----- Jan. 16



NMSU Grants
1500 N. Third St
Grants, NM 87020
www.grants.nmsu.edu

Whom To See:

General Information	(505) 287-NMSU
University Services	
<i>Felicia Casados, Campus President</i>	287-6624
Academic Services	
<i>Dr. Harry Sheski, VP Academic Affairs</i>	287-6641
Admissions/Transcripts	287-6678
Adult Basic Education	
<i>Thomas McGaghie</i>	287-6662
Bachelors of Science in Education	
<i>Kathleen O'Connor</i>	287-6693
Barnes & Noble Bookstore	
<i>Clinton Johnson</i>	287-9271
Business Services	
<i>Gail Gurule, Student Accounts</i>	287-6623
<i>Sharon Loley, Cashiering/Ck Distribution</i>	287-6682
<i>Alice Salcido, Accountant</i>	287-6630
<i>Gaylyn Yanke, VP Business & Finance</i>	287-6633
Dual Credit Coordinator	
<i>James Olguin</i>	287-6620
Education Resource Center	287-6693
Financial Aid	
<i>Nicole Kormick, Processing</i>	287-6621
<i>Beth Armstead, Advising/awards</i>	287-6628
<i>Brian Johnson, Advising/awards</i>	287-6629
Human Resources	
<i>Joanna Torrez</i>	287-6625
Library Services	287-6637
<i>Cecilia Stafford</i>	
Small Business Development Center	287-8221
<i>Clemente Sanchez</i>	
Small Wonders Child Care Center	287-3868
<i>Jackie Hobbs</i>	
Student Services/Veteran's Educational Benefits/Academic Advisers	
<i>Beth Armstead, VP Student Services</i>	287-6628
<i>Brian Johnson, Academic Advisor</i>	287-6629
Testing Center	
<i>Olivia Rael, Coordinator</i>	287-6640
 <u>Program Managers:</u>	
Applied Business/Pre Business-Betty Habiger	287-6646
Automotive Technology - Paul Garcia	287-6635
BSN- Phyllis Fisk	287-6660
Building Trades – Dr. Harry Sheski	287-6641
Communications – Dr. Joan Erben	287-6651
Computer Science – Dr. Harry Sheski	287-6641
Corrections Officer – Michael Richer	287-6670
Criminal Justice –Megan Stoneking	287-6690
Drafting/Welding - Richard Gutierrez	287-6645
Education – Kathleen O'Connor	287-6693
Electrical Trades – Dr. Harry Sheski	287-6624
Electronics – Dr. Harry Sheski	287-6624
Health Sciences - Neal Gallagher	287-6654
Humanities – William Serban	287-6648
Mathematics-Marlene Chavez-Toivanen	287-6652
Natural Sciences –Sharon Walsh	287-6661
Social Sciences –Megan Stoneking	287-6690

Registration Check List IMPORTANT

- Submit the Admission Application if you are a new student or a returning student who has not enrolled in a class for one full year. Apply online at <https://prospective.nmsu.edu> plan on a 2 day turnaround processing period. Application fee is \$20.
- Apply for FAFSA (Pell Grant, loans & work study). *Allow six weeks for processing.* Meet with the financial aid advisor in Student Services.
- Send for official transcripts of high school/GED scores and all colleges attended prior to enrolling at NMSU. **All transcripts must be at NMSU Grants by February 1 for Spring in order to be eligible as a "degree seeking" student for financial aid.**
- Take the computerized College Placement Test (Compass). Pick up a test admission card in the Office of Student Services. You will be tested for placement in English and Mathematics course work. **NOTE: It is not recommended that you enroll in General Education college classes, (classes with a course number ending in "G"), without being concurrently enrolled in or having completed ENGL 111G.**
- Activate your my.nmsu.edu account.* NMSU email is the official mode of communication; contact the Information Technology Dept. if you have problems with your account. (505) 287-6666
- Register for classes **EARLY**. Online courses and some general education courses fill up very quickly. Register at my.nmsu.edu. **If you have a "hold", you will need to see an advisor or the Business Office.**
- Make payment arrangements in the Business Office. **You risk being disenrolled if you have a prior balance & have not made arrangements to pay with the Business Office.**
- Attend the required New Student Orientation if it is your first semester at NMSU Grants.
- Obtain your Aggie ID in Student Services.
- Purchase books **before** the first day of class. The Barnes & Noble Campus Bookstore is located in Martinez Hall, Room 04 or online at nmsu.bncollege.com
- Always feel free to ask questions of the staff if you are unsure of anything. They are glad to help!

Register Online using myNMSU

Logging into myNMSU

1. Open a browser session
2. Access <https://my.nmsu.edu>
3. Enter your **NMSU Username** and **Password**
4. Click **Login**

Check your Registration Status

Before you register all holds must be cleared by the appropriate office

1. Click the **Student and Financial Aid Tab**
2. Click **Registration**
3. Click **Registration Status**

Look-Up a Class & Registration

1. Click the **Student and Financial Aid Tab**
2. Click **Registration**
3. Click **Look Up Classes**
4. Select **Term**
5. Click **Submit**
6. On the **Look Up Classes** page, select any known features of the class.
7. Click **Class Search**
8. Select the checkbox next to any classes you would like to register
9. Click **Register**
10. If a class is full or you need instructor permission, email the instructor requesting permission to register. If the instructor approves, he/she must add your Aggie ID to his/her class. You should then be able to register for the section.
11. After the last date to register, students cannot add, drop or WD online.

Forgot your NMSU Password

1. Open a browser session
2. Access <https://my.nmsu.edu>
3. Click the **forgot your password?** Link
4. Enter your **Social Security Number or Aggie ID** and **Date of Birth**
5. Click **Submit**
6. Answer your secret question
7. Click **Continue**
8. Enter a **Password** and confirm
Click **Continue**

New Mexico State University Grants
1500 N. Third Street
Grants, NM 87020

myNMSU.edu

**ALL STUDENTS MUST
ACTIVATE AN NMSU ACCOUNT &
REGISTER ONLINE**

Spring 2013 Calendar

	Spring Term	8 Week I (MS1)	8 Week II (MS2)
	January 17 – May 10	January 17 – March 12	March 13 – May 10
New Student Orientation	January 10 1:00-4:30pm		
Classes Begin	January 17	January 17	March 13
Late Registration A late fee of \$25 will be assessed	January 17-29	January 17-23	March 13-18
Martin Luther King Holiday (campus closed)	January 21	January 21	
Degree Application Deadline	January 25	January 25	January 25
Last Day to Add a Course	January 29	January 23	March 18
Last Day to Drop a Course without a “W” (Census Date) *If a course is <i>dropped</i> before census date, course will be removed from class schedule. Students may drop themselves from courses through census date. After that, student must meet with an Academic Advisor.	February 1	January 29	March 21
Late Degree Application Deadline	March 1	March 1	March 1
Mid Semester Advising	March 5	March 5	
Last Day to Drop a Course with a “W” *A grade of “W” is assigned to all courses for which a student officially <i>withdraws</i> from <u>after</u> census date.	March 12	February 13	April 15
Spring Break	April 8 - 12	April 8 - 12	April 8 - 12
Spring Holiday (campus closed)	March 29	March 29	March 29
Last Day to Withdraw from the University Students who do not officially withdraw from a course or from the University and fail to attend classes may receive failing grades and will be liable for all tuition and fees. Students may be required to repay a portion or all financial aid received	April 19	February 28	April 30
Final Exam Week	May 6-10		
Last Day of Classes	May 10	March 12	May 10
Commencement	May 10	May 10	May 10

NMSU Spring Service Hours**January 02 – May 11****Student Services****January 2- 11**

Monday-Friday 8am-5pm

January 14 - January 29

Monday-Thursday 8am-6pm

Friday 8am-5pm

January 30 – May 10

Monday-Thursday 8am-5:30pm

Friday 8am-5pm

Business Office (Student Accounts, Cashier's Office, Check Distribution)**January 2- 11**

Monday-Friday 8am-5pm

January 14 – January 29

Monday-Thursday 8am-6pm

Friday 8am-5pm

January 30 – May 10

Monday-Friday 8am-5pm

Adult Basic Education

Monday-Thursday 8am-9pm

Friday 8am-5pm

Student Success Center

Monday-Thursday 9am-7pm

Friday 10am-4pm

Saturday 10am-2pm

Student Open Computer Lab

Monday-Thursday 8am-8pm

Friday 8am-5pm

Saturday 10am-2pm

Math Tutoring Lab

Room 124 Hours Posted

Education Resource Center

By Appointment

Library

Monday-Thursday 8am-8pm

Friday 8am-5pm

Saturday 10am-2pm

Barnes & Noble Campus Bookstore**Rush Hours for Spring****January 14-18**

Monday 10am-5pm

Tuesday 1pm-6pm

Wednesday 10am-5pm

Thursday 1pm-6pm

Friday, January 18 10am-3pm

January 21-25

Monday 10am-3pm

Tuesday 1pm-4pm

Wednesday 12pm-6pm

Thursday 1pm-4pm

Friday 10am-4pm

Regular Hours for Spring**January 25 – May 10**

Monday 10am-3pm

Tuesday 1pm-4pm

Wednesday 10am-3pm

Thursday 1pm-4pm

Friday Closed

Please visit www.nmsubookstore.com for Barnes & Noble at NMSU operating hours

- Last day to return textbooks is January 24, 2013, with a receipt.
- Textbook returns – January 25-February 14, 2013 requires receipt and proof of schedule change.
- Pre-approved students can charge books to their accounts Tuesday, January 8 – February 15, 2013.

Aggie ID or class schedule must be presented at cash register to purchase books tax-free.

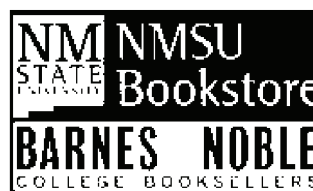
Located in Martinez Hall, Room 04

Costs – Spring 2013

Tuition

In-District

Per semester, 12-18 credits	\$ 891
Per credit hour 1-12 and over 18	\$ 74.25
Per credit earned by examination	\$ 74.25

Out of District

Per semester, 12-18 credits	\$ 978
Per credit hour 1-12 and over 18	\$ 81.50
Per credit earned by examination	\$ 81.50

Non-Resident

Per semester, 12-18 credits	\$1848
Per credit hour 1-12 and over 18	\$ 154
Per credit earned by examination	\$ 154

Spring Fees

Fees

Admission Application	\$ 20
A one-time, non-refundable fee for first time admission to NMSU Grants	
Late Registration Fee	\$ 25
Assessed the first day of classes	
Deferred Payment Fee	\$ 20
Will be assessed if not paid in full by January 30, 2013	
Graduation Fee for Spring (Associate Candidate)	\$ 25
Additional \$25 late fee beginning January 28, 2013	
Graduation Fee (Certificate Candidate)	\$ 10
Due by May 3, 2013	
Web-Based, ITV, & Online Hybrid	\$ 25

Lab Fees

ART 150, 151, 260	\$ 25
AUTO 105, 112, 117, 120, 255	\$ 25
BCT 105, 200, 255	\$ 25
BIOL 110, 221L, 226	\$ 10
CHEM 110, 112.....	\$ 10
ELT 110, 160, 205, 221	\$ 25
OEEM 120L	\$ 25
OEEM 101	\$ 10
OEET 110, 115, 205, 210	\$ 25
OEPS 250, 280	\$ 135
WELD 105, 120, 130, 140, 211, 295.....	\$ 25

Accounts must be paid in full by:

May 15, 2013

Courses less than 5 weeks must be paid in full before classes start. Previous debts to NMSU must be paid in full before you register. Class attendance without tuition and/or fee payments makes you liable for semester charges and may cancel your enrollment.

Senior Citizens

On a space-available, last day of late registration basis, seniors (65+) may enroll for up to 6 credits at \$7 per credit, non-degree seeking status. State law requires that senior citizens taking more than 6 credit hours be charged full rate for all credits based on in-district or out-of-district residency.

Withdrawal

A withdrawal form must be completed with Student Services to withdraw from a course or from the University. Not following this procedure may result in "F's" for all courses for which you are registered. Students are liable for all tuition and fees.

**All contents of this publication
is subject to change at anytime
by appropriate administrative procedure**

TERMS AND CONDITIONS OF PROCESSING A COURSE REGISTRATION

By enrolling in classes at the New Mexico State University (NMSU), a student makes a financial commitment to pay the tuition and fee charges associated with that enrollment. The enrollment action constitutes a financial obligation between the student and NMSU and that all proceeds of this agreement will be used for educational purposes and constitute an educational loan pursuant to 11 U.S.C. § 523(a) (8).





The following terms and conditions are financial requirements of each student’s education related to their registration for a term at New Mexico State University. The payment of tuition and fees is the obligation of the student. **By processing a course registration either via the Web or by submitting a course request card to an academic student registration area, a student acknowledges they have read and agree to the following terms and conditions:**

- Registration constitutes a financial agreement between you (“Student”) and New Mexico State University (“NMSU”). Tuition, fees and other charges you incur, including but not limited to bookstore charges (“Charges”), shall be added to your student account and are considered a loan for educational benefit.
- Once you formally register for classes, you assume the responsibility for understanding New Mexico State University’s official policies concerning schedule changes, satisfactory academic progress and the financial policies of the University as described in the ‘New Mexico State University Undergraduate Catalog’ or ‘New Mexico State University Graduate Catalog’ for the term of enrollment.
- Installment payment arrangements will be automatic with a non-refundable deferred payment fee for any Charges not paid in full within ten (10) business days of the start of the term. For specific date, please check the ‘Schedule of Classes’ for the enrollment term.
- Charges may be prepaid at any time in whole or in part without premium or penalty.
- Charges left unpaid for prior terms will result in disenrollment from your current term courses unless payment arrangements are made with University Accounts Receivable prior to the disenrollment date. For that specific date, check the ‘Schedule of Classes’ for the enrollment term.
- In the event that you become delinquent in paying Charges or default in repaying Charges you will be liable for collection fees and any other costs incurred by New Mexico State to collect any monies due from you.
- Students withdrawing after the stated refund dates remain liable for full tuition and fee charges. Collection costs incurred in the event of delinquency shall be at the expense of the Student.
- NMSU accepts payment via student financial aid and third party sponsorship, but the responsibility for payment remains with the student. It is your responsibility to keep track of your account balance and any funding sources. If financial aid is not granted or if third party sponsors do not pay within a reasonable period, the student will be required to pay the full amount due.
- If the New Mexico State University prevails in a lawsuit to collect on this financial obligation, Student will pay NMSU's court costs, collection agency costs, and attorney's fees in an amount the court finds to be reasonable.
- You consent to receive email notifications to your @nmsu.edu e-mail address of the availability of an E-Bill (Electronic Billing Statement) and consent to review billing statement information on NMSU Web Payment System.
- It is your responsibility to check your myNMSU email daily and maintain a current postal address to ensure receipt of all University correspondence.

SPRING REGISTRATION IS CONSIDERED COMPLETED ONCE A STUDENT HAS REGISTERED FOR A COURSE(S). IF A STUDENT CHOOSES NOT TO ATTEND NMSU FOR A TERM, SHE/HE MUST OFFICIALLY WITHDRAW FROM NMSU FOR THAT SPECIFIC TERM.

STUDENTS WITH A PREVIOUS SEMESTER BALANCE MAY HAVE THEIR COURSES FOR SPRING CANCELLED IF THEY HAVE NOT MADE PAYMENT ARRANGEMENTS FOR PREVIOUS TERMS DEBTS WITH THE BUSINESS OFFICE BY JANUARY 30, 2013 BY 5:00PM FOR SPRING 2013.

METHOD OF PAYMENT

Mail  Mail all check payments to: New Mexico State University Grants 1500 N. Third Street Grants, NM 87020	Telephone  Questions: (505)287-6682 Payments (505)287-6682	In person  By visiting the cashier office located in Martinez Hall	Online  Pay online at: pay.nmsu.edu
---	--	--	---

PLEASE NOTE THAT THE UNIVERSITY DOES NOT ACCEPT DEMAND DRAFTS

TUITION PAYMENT

You complete registration by paying tuition and fees as follows:

- 1) In full with cash, check, or credit card (Discover, MasterCard, VISA), or
- 2) By presenting verification of financial aid award, grant, scholarship, or program authorization to the Business Office.

PAYMENT PLAN

By enrolling in classes at the New Mexico State University (NMSU), a student makes a financial commitment to pay the tuition and fee charges associated with that enrollment. The enrollment action constitutes a financial obligation between the student and NMSU and that all proceeds of this agreement will be used for educational purposes and constitute an educational loan pursuant to 11 U.S.C. § 523(a) (8).

Students withdrawing after the stated refund dates remain liable for full tuition and fee charges. Collection costs incurred in the event of delinquency shall be at the expense of the borrower. Although the University accepts payment via student financial aid and third party sponsorship, the responsibility for payment remains with the student. If financial aid is not granted or if third party sponsors do not pay within a reasonable period, the student will be required to pay the full amount due.

All outstanding charges not paid in full by January 30 will automatically be placed on a payment plan and a payment plan fee of \$20.00 will be assessed. Outstanding charges will be divided into four equal payments for Spring.

REFUND OF TUITION AND FEES

Students officially withdrawing or dropping courses during the Spring 2013 semesters are eligible to receive a refund as follows:

Spring 2013

Full Term (January 17 – May 10)

Through February 3	100%
February 4 – February 19	50%
February 20 – March 3	25%

8 Week I (January 17 – March 12)

Through January 29	100%
January 30 – February 1	50%
February 2 – February 7	25%

8 Week II (March 13 – May 10)

Through March 22	100%
March 23 – March 29	50%
March 30 – April 5	25%

**REFUND PERCENTAGES ARE BASED UPON SEMESTER CHARGES, NOT AMOUNTS PAID.
ALL REFUNDS ARE APPLIED TOWARD AMOUNTS OWED.**

- The refund schedule on this page applies when courses are dropped and a tuition adjustment is necessary.
- Refunds for dropped credits will not be issued until after the last day to add a course.
- No refunds will be made on classes of less than five weeks duration.
- Part of Term refunds are based on class days completed.
- In cases of academic or disciplinary suspension, eligibility for refund will depend on the conditions of the suspension and will be entirely at the option of the University.
- Special Fees are refunded in full through the 100% refund period; thereafter, fees are non-refundable.
- Withdrawal refunds are calculated as of the date the withdrawal form is completed with the Registrar's Office.
- **Recipients of financial aid grants and loans who drop credits or withdraw may be required to return all or a portion of awarded Title IV funds.**

Students who are enrolled but choose not to attend must officially withdraw from the University. To officially withdraw, please go to the Registrar's Office.

Any funds remaining, after paying University expenses, will be available to students through the NMSU Grants Business Office. Prior term charges due to the University and non-institutional charges (i.e. Health Center charges, Degree fees, etc.) cannot be taken from a student's Financial Aid and/or Scholarship awards, therefore a balance may still be due to the University after a Financial Aid Refund is issued to a student.

Direct Deposit of Financial Aid to a student's checking account is available. To sign up for this service log on to my.nmsu.edu and click on the direct deposit link under student financial aid to securely input your bank account information.

Instructional Support Services

Adult Basic Education (ABE)

Adult Basic Education (ABE) programs offer adults the opportunity to begin and/or complete a basic education through the twelfth grade. They also provide a variety of educational programs that can help you meet your goals. A basic education will improve your opportunities for obtaining or retaining employment or going to college.

Included in the adult basic education instructional programs are basic literacy and GED (High School Equivalency Diploma). Student-support services, which promote educational success, include assessment, student orientation, self-paced studies, advising and referral services, and help from tutors on an individual and small-group basis. In addition, classes are offered each semester. There is no charge for ABE Classes, services, or textbooks. Located in Room 120, Martinez Hall.

Computer Labs

NMSU Grants campus offers state-of-the-art computer hardware and software to students enrolled at NMSU. Six labs are located throughout the campus. Two labs are available for student use outside of class. An open lab in room 127 contains Gateway Pentium IV desktop computers with software applications used by several disciplines.

Instructional Technology Services

Room 06, Martinez Hall, across from the Library

Library Services

This is on the main floor, Martinez Hall. It hosts more than 23,000 titles in addition to an extensive audio and video collection. Eight Pentium IV Gateway computers provide online access to article databases. Eight desktop computers are available for public use during operating hours.

Mathematics Lab

The Math Lab in Martinez Hall, room 124, provides all levels of assistance for developmental math through college algebra. The lab, staffed by a teaching technician, offers tutoring and testing services, and computer access.

NASNTI Grant

The U.S. Department of Education awarded a five-year Native American Serving Non-Tribal Institutions Grant (NASNTI) to New Mexico State University Grants Campus in October 2011 to expand access to educational opportunities for Cibola County, New Mexico residents. As part of the grant initiative, two priorities serve as focal points which include: 1) outreach to Native American, low-income, and at-risk clients in Cibola County with a myriad of entry points to access higher education, and 2) to enable more data-based decision making to improve services and strategic planning of institutional practices and services. Acoma Pueblo and Tohajiilee Navajo community outreach sties have been established to provide the following services: 1) Adult Basic Education (GED) program, 2) Dual enrollment with high school students in the Cibola County Service area, and 3) college success and retention strategies including online and course offerings at each outreach center. Professional tutors in basic core requirements are available at the Student Success Center and we also have a Native American Student Program to provide extracurricular activities, support, and educational opportunities for all students. For more information, please contact Dr. Shawn Secatero, NASNTI Director at (505) 287-6699

Online Canvas/Web-based Courses

- Any course with an online element (full or partial) will be at <http://learn.nmsu.edu>. Use the same username and password as you would for your my.nmsu.edu account.
- These courses require special skills, aptitude, and additional time commitment.
- You can obtain a list of technology skills and system requirements by going to: <http://distance.nmsu.edu> and selecting "prospective students"
- There is an additional \$25 course fee for NMSU Grants online courses. 100% online and hybrid have course fees.
- Log into learn.nmsu.edu to start your course on the 1st day of classes.

Student Success Center (SSC)

Located in Martinez Hall, room 125, this center offers a quiet study area, free one-on-one tutoring and test proctoring for students in most subjects, including writing, math, and many "G" courses. The SSC is also the college-testing center, administering the college placement test (COMPASS) to new students.

Small Business Development

Small Business Development Center (SBDC)

The Small Business Development Center (SBDC) is located at 701 E. Roosevelt Ave., Grants, NM 87020, offers free specialized consulting and guidance for business owners, prospective owners, and managers. The SBDC is designed with the small business person in mind. Whether in business for some time or just starting out, the SBDC can help address issues and problems encountered by small business owners. As a member of the New Mexico Small Business Development Center Network, SBDC's experienced staff can help you:

- Explore business ownership opportunities in Cibola County & access a wealth of business resources
- Start a new business or make an established one more efficient and profitable.
- Improve your management skills.

Business Education

The SBDC offers individualized tutoring in accounting, marketing, and various aspects of management that can help you avoid costly mistakes. Special arrangements can be made for SBDC staff to come to businesses to discuss strategies. Seminars and workshops are available to improve business and management skills. For more information, contact **Clemente Sanchez** at 287-8221 or at <http://grants.nmsu.edu/sbdc.html>

Campus Programs & Policies

Academic Advising

The Student Services Office is located in Martinez Hall, Room 5. Make an appointment or walk-in during office hours, to see an adviser prior to registration to review your degree plan. On-line advising sessions are available at grants.nmsu.edu.

STAR Degree Audit

The Student Academic Requirements (STAR) degree audit program is a web-based service that allows NMSU students to run online degree checks on academic programs. For more information, go to www.degreeaudit.nmsu.edu

Students with Disabilities

In compliance with the Americans with Disabilities Act (ADA), students with disabilities who need special services in the classroom or have difficulty gaining access to any university building, should contact Beth Armstead, Vice President for Student Services at 287-NMSU (6678). Students must self-disclose their need for accommodations.

Student RIGHT-TO-KNOW and Campus Security Act

NMSU is required to provide to you information in accordance with Federal Regulation 34 CFR Part 86 of the Department of Education and the Student Right-to-Know and Campus Security Act. You can access the information by going to www.nmsupolice.com, and then selecting the "Annual Reports" link on the left menu

Student Code of Conduct

The Vice President for Student Affairs (NMSU Las Cruces) establishes and enforces standards of conduct for all NMSU students. The Vice President for Student Services, Beth Armstead, enforces conduct for the Grants campus. Obtain your copy of the Student Code of Conduct in Student Services or online at grants.nmsu.edu.

Course Transfer

The institution to which you transfer determines transferability of courses taken at NMSU Grants. Usually, general education courses (marked "G") are accepted by other institutions when these courses apply to a degree program at the school. Technical, vocational, or special courses (OE/BOT) may be applied to Baccalaureate degrees only upon petition to and approval from the institution to which you transfer. For information, contact an adviser or review a copy of the latest NMSU Grants catalog and consult the institution you may plan to transfer credits to.

Children on Campus

Children should not be left unattended or be permitted to disrupt classes. Small Wonders Child Care Center, on the NMSU Grants campus, offers childcare to students, faculty, and staff for children, ages 6 weeks to 12 years, for an established fee. Contact Small Wonders Child Care Center, 287-3868. Apply early as there is often a waiting list. The Center does not offer "drop in" care.

NMSU Cibola County Extension Service

J.Wendy Brown, MA. Program Director
Barbara Baca, Administrative Secretary
Gwen Jaramillo, ICAN Educator.
Jeanne Naramore, ICAN Educator
Chase Elkins, Extension Agent

- **Just Be It: Nutrition and Fitness Programs for Youth K-5th grade/Organ Wise Guys**
- **4-H Youth Ballet – Every Tuesday Family Center 3:30 -4:15**
- **ICAN – Nutrition classes for Adults and Kids**
- **Parenting Classes -Mondays 10:30 a.m. Family Center 12 sessions**
- **4-H Clubs, sign up before May 1, 2013**

For more information regarding these services contact the office at:

551 Washington Ave
Grants, NM 87020

Phone: 505-287-9266

Email: cibola@nmsu.edu

Online: cibolaextension.nmsu.edu

Admissions

All new, readmitted, and transfer students must apply for admissions prior to registration. Students will be admitted as either degree seeking or non-degree seeking. All applicants must be either high school graduates or must have successfully passed the GED exam. Transfer students must verify that they are eligible to return to any previously attended colleges. Admission applications are available from the NMSU Grants Student Services Office or by applying online.

To apply for admissions or readmission:

- 1- Complete an application for admissions. If you are applying for financial aid or veterans benefits, you must apply as degree seeking
- 2- Submit the completed application to NMSU Grants, 1500 N. Third Street, Grants, NM 87020. If you have never taken classes at NMSU before, you must include with your application a one-time, non refundable \$20 admission fee.
- 3- Request that your GED scores or transcripts from former high schools and/or colleges be sent directly to NMSU Grants.
- 4- An Admission Status Letter will be provided to you upon request. **Note:** Student in non-degree admission status is not eligible for Financial Aid or Veterans Benefits.

Changing Admissions or Enrollment Status

The deadline for changing admission status from non-degree to degree seeking is census date. After this date, students will remain in the non-degree seeking status for the term. The deadline for changing enrollment status from credit to audit or graded to S/U is census date.

Social Security Numbers/NMSU Aggie ID in Student Records

Social security numbers are collected for prospective and current students for administrative coordination and record identification purposes only. Although procedures have been established by the Registrar for assignment or an alternative number upon request, students who wish to be employed on campus or to receive financial aid are required by law to provide their social security number for administrative use. Further, the university is mandated by federal tax regulations to provide tuition and fee payment information to the student and the Internal Revenue Service, so that applicable educational tax credits may be computed. The social security number will be necessary to submit this tax reporting. In the event that the university does not have the social security number for a student, a reasonable effort will be made to obtain this information. The social security number is a confidential record and is maintained as such by the university in accordance with the Family Educational Rights and Privacy Act. A NMSU Aggie ID number is assigned to each admitted and enrolled student and will be used as the primary identifier when enrolling for classes through Student Services, for obtaining printed class schedules, and for all Business Office transactions. The Aggie ID number can be found after logging into your MyNMSU account.

Financial Aid/Scholarships

Title IV Code is 008854

You must register for classes prior to the date posted in the Financial Aid Office to be eligible for aid. Students will be billed for 100% of aid they received for classes they never attended.

Financial Aid and/or Scholarship Awards will be automatically applied to your NMSU account through the University Accounts Receivable Office. Any funds remaining after paying University expenses will be available to you through direct deposit or check. You may sign up for direct deposit through my.nmsu.edu. If you do not choose direct deposit, you may pick up your check at the NMSU Grants Business Office.

Financial Aid cannot be disbursed until your Financial Aid file is complete. You can review the status of your financial aid through your my.nmsu.edu and/or by contacting the NMSU Grants Financial Aid Office. To avoid delays, you should complete your financial aid files accurately and early. If you have not been awarded financial aid, you must make payment arrangements at the NMSU-Grants Business Office. Grant and Loan financial aid for the first and second 8-week sessions will be paid at the beginning of the 16-week semester. The cut-off date to add classes for financial aid purposes will be posted at the NMSU Grants Financial Aid counter. Financial Aid may not pay for the courses added after the cut-off date. **You will NOT be automatically withdrawn from the University if you do not attend classes. You must officially withdraw at the NMSU Grants Admissions and Records Office.**

To receive financial aid, you must be degree-seeking with the NMSU Grants Admissions and Records Office.

You must notify the NMSU Grants Financial Aid Office of any and all additional resources: scholarships, tuition waivers, stipends, WIA, DVR, state or federal awards, and others. All financial aid offers are subject to revision due to changes in policy, law, regulations, or errors in funding. You are responsible to repay excess funds disbursed due to any of these reasons.

You must be enrolled in at least 6 credit hours to receive a loan award. First-time borrowers must complete an online Debt Management Entrance Counseling and Master Promissory Note at: <https://studentloans.gov> prior to loan disbursement.

Satisfactory academic progress will be monitored to determine eligibility for Financial Aid. Satisfactory progress includes:

- Maintaining a cumulative grade point average of 2.0 for undergraduates,
- Satisfactory completion of at least 66.67% of credits hours attempted, and
- A maximum time frame to complete a degree (usually 99 attempted hours for an associate degree)

VA Benefits - If you plan to use VA benefits, you must have your class(es) approved by an advisor prior to registration. All new students should apply online for Educational Benefits at gibill.va.gov. Chapter 31 & 33 participants are not responsible for paying tuition. All other VA Chapter participants are responsible for paying their tuition per the Payment Plan Schedule.

Distance Education

NMSU College of Extended Learning provides comprehensive distance learning opportunities to meet diverse educational and professional needs anytime, anywhere. As New Mexico's land-grant institution, NMSU has a university-wide mission to expand the capacity of extension, outreach, and distance education to communities across the state. NMSU's distance education degree programs are designed to serve students who may not be able to pursue an education through traditional means. NMSU offers Bachelor degree completion programs, Masters and Doctorate programs, and a number of Certificate and Licensure options.

Technology-Based Programs are delivered using WebCT, Centra, ITV (Interactive Television), and other learning technologies.

Cost for upper division courses (300 & 400 level): Current Las Cruces campus tuition and fees plus \$25 distance education fee per credit.

If you are interested in Teacher Education, Nursing, Criminal Justice, Business, Sociology, Information Communication Technology, Hotel Restaurant & Tourism Management, these degrees may be available at the Bachelor, Master and Doctoral levels. For further information, contact the College of Extended Learning, Distance Education toll-free 1-800-821-1574 or (575) 646-4692, email: distance@nmsu.edu or on-site in Milton Hall room 185 during regular business hours. Distance Education Website is <http://distance.nmsu.edu>.

BSN in Nursing (RN Program)

This is a unique program. The nursing coursework will be conducted via live instructional television (ITV) from NMSU – Las Cruces. Students will participate actively in the lectures and coursework conducted in Las Cruces while sitting in a classroom on the Grants Campus.

The clinical and skills portion of the program will occur at the Grants Campus and be led by an NMSU nursing instructor.

Requirements: Maintain a minimum prerequisite 3.0 GPA

Costs: Current Las Cruces campus tuition and fees plus a \$25 per credit hour distance education fee.

To apply: Check with the School of Nursing in NMSU Las Cruces at (575) 646-3812 for the most current admissions requirements. NMSU Grants Advisers are available for pre-nursing advising.

Applications are accepted in early February for fall admissions.

Student Confidentiality Form

The following information has been designated as Directory Information, which is subject to release to the public under the Buckley Amendment (PL 93-380), "The Family Educational Rights and Privacy Act of 1974":

Student's name, address, e-mail address, telephone listing, date and place of birth, classification, major field of study, participation in officially recognized activities and sports, weight and height of members of athletic teams, dates of attendance, degrees and awards received, and the most recent previous educational agency or institution attended by the student.

Other information regarding disclosure of student data is posted at the Student Services office in compliance with the Act.

If you are a **currently enrolled** student and **object** to the release of this information to all publics, you must return this form to the Student Services office in person.

Last Name

First

Middle

Aggie ID

Signature

Date

Release form for Electronic, Print and Video

Occasionally photographs, videos, or other audio or visual images of students may be used by New Mexico State University Grants for course materials, the NMSU Grants website, dissemination in brochures and other promotional materials such as our catalog, schedule of classes, student handbook, promotional flyers or other public presentation documents.

Furthermore, such photographs, film, video recording, or other audio or visual images, may be used free and clear of any claim whatsoever on my part.

By signing this permission form, you authorize NMSU Grants to utilize any photo of you may be in for marketing, publications, public relations, etc.

Thank you and Go Aggies!

Student (please print)

Aggie ID

Signature

Date

Witness:

Date:

No Release form for Electronic, Print and Video

Occasionally photographs, videos, or other audio or visual images of students may be used by New Mexico State University Grants for course materials, the NMSU Grants website, dissemination in brochures and other promotional materials such as our catalog, schedule of classes, student handbook, promotional flyers or other public presentation documents.

Furthermore, such photographs, film, video recording, or other audio or visual images, may be used free and clear of any claim whatsoever on my part.

Complete this form if you are **currently enrolled** student and **object** to photos of you at NMSU activities being published.

Student (please print)

Aggie ID

Signature

Date

Parent Name (please print)

Signature

Date

SPRING 2013
January 17 – May 10

Note	CRN	COURS	PTRM	CR	Course Title	Time	Day	Place	Instructor	
ACCT-ACCOUNTING										
	22170	ACCT 251	G01	3	MANAGEMENT ACCOUNTING	WEB	WEB	WEB	WEB	Habiger Betty
	22174	ACCT 251	G02	3	MANAGEMENT ACCOUNTING	1700-1815	M	GRGQ	121	Habiger Betty
	22177	ACCT 252	G01	3	FINANCIAL ACCOUNTING	WEB	WEB	WEB	WEB	Habiger Betty
	28911	ACCT 252	G02	3	FINANCIAL ACCOUNTING	1700-1815	T	GRGQ	121	Habiger Betty
AHS-ALLIED HEALTH SCIENCE										
	28715	AHS 120	G01	3	MEDICAL TERMINOLOGY	WEB	WEB	WEB	WEB	Gallagher Neal
	28754	AHS 120	G02	3	MEDICAL TERMINOLOGY	1745-1900	TR	GRGN	309	Broach Nancy
	28716	AHS 153	G01	4	INTRO ANTMY/PHYSLGY I	WEB	WEB	WEB	WEB	Gallagher Neal
ANTH-ANTHROPOLOGY										
	29029	ANTH 125G	G01	3	INTRO WORLD CULTURES	1730-2000	W	GRGQ	107	TBA
	29030	ANTH 203G	G01	3	INTRO LANG & CULT ANTH	0900-1200	R	GRGQ	107	TBA
ART-ART										
	29083	ART 150	G01	3	DRAWING I	1200-1500	MW	GRGN	311	Romero Alfred
	29084	ART 151	G01	3	DRAWING II	1300-1600	TR	GRGN	311	Romero Alfred
	29085	ART 260	G01	3	INTRODUCTION TO	0900-1200	TR	GRGN	311	Romero Alfred
	28717	ART 294	G01	3	PHOTOGRAPHY II	1400-2100	T	GRGN	305	MacDonald Ellen
ASTR-ASTRONOMY										
	28897	ASTR 110G	G01	4	INTRDN TO ASTRONOMY	1715-2045	F	GRGQ	101	O Keefe William
AUTO-AUTOMOTIVE TECHNOLOGY										
	29027	AUTO 105	G01	4	WELDING	1800-2030	TR	GRGQ	051	Sandoval Alex
	29040	AUTO 112	G01	5	BASIC GASOLINE ENGINE	1020-1205	MTWR	GRGQ	052	Garcia Paul
	29041	AUTO 117	G01	5	ELT ANLYS TUNE-UP GAS	0810-1000	MTWR	GRGQ	052	Garcia Paul
	29043	AUTO 120	G01	4	ELECTRICAL SYSTEMS	1330-1635	MW	GRGQ	052	Garcia Paul
	29077	AUTO 139	G01	4	AUTO COMPTR CONTROLS	1330-1635	TR	GRGQ	052	Garcia Paul
BCT-BUILDING CONSTRUCTION TECH										
	29021	BCT 105	G01	3	WOODWORKING SKILLS II	1730-2000	TR	GRGN	302	Prewett Earl
	29023	BCT 200	G01	8	BUILDING TRADES II	0900-1600	TR	GRGN	302	Prewett Earl
	29024	BCT 255	G01	3	FURNITURE MAKING	0900-1400	S	GRGN	302	Prewett Earl
BIOL-BIOLOGY										
	28900	BIOL 110G	G01	4	CNTMPRY PRBLM IN BIOL	0930-1510	F	GRGQ	110	Rael Rolando
	28898	BIOL 221	G01	3	INTRO TO MICROBIOLOGY	1400-1520	TR	GRGQ	110	Rael Rolando
	28899	BIOL 221 L	G01	1	INTRO MICROBIOL LAB	1530-1830	T	GRGQ	110	Rael Rolando
	28901	BIOL 226	G01	4	HUMAN ANATOMY/PHYS II	WEB	WEB	WEB	WEB	Walsh Sharon
						1500-1800	M	GRGQ	110	Walsh Sharon
BLAW-BUSINESS LAW										
	22195	BLAW 230	G01	3	BUSINESS LAW	WEB	WEB	WEB	WEB	TBA
BMGT-BUSINESS MANAGEMENT										
	28912	BMGT 216	G01	3	BUSINESS MATH	WEB	WEB	WEB	WEB	Habiger Betty
	28915	BMGT 221	G01	3	CO-OP EXPERIENCE I	WEB	WEB	WEB	WEB	Habiger Betty
	28914	BMGT 240	G01	3	HUMAN RELATIONS	WEB	WEB	WEB	WEB	Habiger Betty
C E-CIVIL ENGINEERING										
	28909	C E 151	G01	3	INTRDN TO CIVIL ENGR	1500-1610	TRF	GRGQ	111	Hebert Jonathan
C EP-COUNSELING & EDUC PSY										
	22000	C EP 110G	G01	3	HUMAN GROWTH/BEHAVIOR	WEB	WEB	WEB	WEB	Adams Kumen
	28867	C EP 110G	G02	3	HUMAN GROWTH/BEHAVIOR	1715-1830	MW	GRGQ	106	Ramirez Alma
	28865	C EP 110G	G03	MS1	3	HUMAN GROWTH/BEHAVIOR	WEB	WEB	WEB	O'Connor
	28866	C EP 210	G01	MS2	3	EDUCATIONAL PSY	WEB	WEB	WEB	O'Connor
	22006	C EP 210	G02	3	EDUCATIONAL PSY	WEB	WEB	WEB	WEB	Adams Kumen
	29638	C EP 210	G03	3	EDUCATIONAL PSY	WEB	WEB	WEB	WEB	Stockdale
						1800-1900	MW	GRGN	302	Stockdale
C J-CRIMINAL JUSTICE										
	22720	C J 101G	G01	3	INTRO CRIMINAL JUSTICE	WEB	WEB	WEB	WEB	Stoneking Megan
	22727	C J 199	G01	3	CRIMINOLOGY THEORIES	WEB	WEB	WEB	WEB	Faught-Hollar
	22730	C J 199	G02	3	ELDER LAW	WEB	WEB	WEB	WEB	Faught-Hollar
	22731	C J 199	G03	3	HUMAN TRAFFICKING	WEB	WEB	WEB	WEB	Stoneking Megan
	22732	C J 205	G01	3	CRIMINAL LAW I	WEB	WEB	WEB	WEB	Lucero Gloria
	22858	C J 210	G01	3	AMER LAW ENFRCHT SYTM	WEB	WEB	WEB	WEB	Lucero Roshanna
	22859	C J 230	G01	3	INTRN TO CORRECTIONS	WEB	WEB	WEB	WEB	Lucero Roshanna
	29031	C J 230	G02	3	INTRN TO CORRECTIONS	1730-2000	T	GRGQ	107	Stoneking Megan
	22860	C J 250	G01	3	COURTS/CRMNL JUST SYT	WEB	WEB	WEB	WEB	Lucero Gloria
C S-COMPUTER SCIENCE										
	28649	C S 110	G01	3	COMPUTER LITERACY	1600-1715	MW	GRGN	307	Gallegos Gabriel
	28650	C S 110	G02	3	COMPUTER LITERACY	1730-1845	MW	GRGN	307	Gallegos Gabriel
	28651	C S 110	G03	3	COMPUTER LITERACY	WEB	WEB	WEB	WEB	Gallegos Gabriel
	28858	C S 110	G04	MS2	3	COMPUTER LITERACY	WEB	WEB	WEB	Prieto Marcos
	28859	C S 209	G01	3	NETWORK ADMINISTRATION	WEB	WEB	WEB	WEB	TBA

CCDE-DEVELOPMENTAL ENGLISH

28720	CCDE 105 N	G01	4	EFFTV CMNCTN SKILLS	0910-1200	S	GRGQ	101	Erben Joan
28721	CCDE 105 N	G02	4	EFFTV CMNCTN SKILLS	1715-1855	MW	GRGQ	105	Calvert Rosemary
28722	CCDE 110 N	G01	4	GENERAL COMPOSITION	1000-1140	MW	GRGQ	101	Burke Gail
28723	CCDE 110 N	G02	4	GENERAL COMPOSITION	0910-1200	S	GRGQ	101	Erben Joan
28724	CCDE 110 N	G03	4	GENERAL COMPOSITION	1830-2010	MW	GRGN	309	Romero Alfred

CCDM-DEVELOPMENTAL MATHEMATICS

28874	CCDM 100 N	G01	4	MATH PREP COLLEGE	1715-1915	MW	GRGQ	102	Epler John
28875	CCDM 100 N	G02	MS1 4	MATH PREP COLLEGE	1300-1510	MTWR	GRGQ	123	Lyons Connie
28876	CCDM 103 N	G01	4	PREALGEBRA (I/P)	1840-2050	TR	GRGQ	124	Lowther Mark
28877	CCDM 103 N	G02	4	PREALGEBRA (I/P)	1300-1510	MW	GRGQ	124	TBA
28878	CCDM 103 N	G03	4	PREALGEBRA (L)	1840-2050	MW	GRGQ	124	Calvert Ronald
28879	CCDM 103 N	G04	4	PREALGEBRA (L)	1425-1635	TR	GRGQ	102	Klumpenhower
28880	CCDM 103 N	G05	MS2 4	PREALGEBRA (L)	1300-1510	MTWR	GRGQ	123	Lyons Connie
28881	CCDM 112 N	G01	MS1 4	DVLPMNTL ALGEBRA I (L)	0955-1205	MTWR	GRGQ	124	Lyons Connie
28882	CCDM 113 N	G01	MS2 4	DVLPMNTL ALGEBRA II (L)	0955-1205	MTWR	GRGQ	124	Lyons Connie
28883	CCDM 114 N	G01	4	ALGEBRA SKILLS (I/P)	1840-2050	TR	GRGQ	124	Lowther Mark
28884	CCDM 114 N	G02	4	ALGEBRA SKILLS (I/P)	1300-1510	MW	GRGQ	124	TBA
28885	CCDM 114 N	G03	4	ALGEBRA SKILLS (L)	1840-2050	MW	GRGQ	103	Prewett Janet
28886	CCDM 114 N	G04	4	ALGEBRA SKILLS (L)	1425-1635	MW	GRGQ	102	Klumpenhower

CHEM-CHEMISTRY

28903	CHEM 110G	G01	4	PRINC & APPL OF CHEM	WEB	WEB	WEB	WEB	Rael Rolando
					1000-1300	T	GRGQ	110	Rael Rolando
28904	CHEM 112G	G01	4	GENERAL CHEMISTRY II	1000-1120	MW	GRGQ	110	Walsh Sharon
				GENERAL CHEMISTRY LAB	1000-1300	R	GRGQ	110	Walsh Sharon

CMT-CREATIVE MEDIA TECHNOLOGY

22575	CMT 130	G01	3	WEB DESIGN I	WEB	WEB	WEB	WEB	Mann Thomas
28863	CMT 135	G01	3	INTRO TO 3D COMP ANIM	0815-0945	MW	GRGQ	122	Gutierrez
28864	CMT 150	G01	3	2D ANIMATION	0815-0945	TR	GRGQ	122	Gutierrez
29356	CMT 190	G01	MS1 3	DIG VID PROD I	1000-1700	S	GRGN	301	TBA

COLL-COLLEGE

29050	COLL 101	G01	MS1 3	COLLEGE/LIFE SUCCESS	1730-1900	TR	ACOMA	TBA	Simpson Rachelle
29639	COLL 101	G02	3	COLLEGE/LIFE SUCCESS	WEB	WEB	WEB	WEB	Brown Juana
29640	COLL 101	G03	3	COLLEGE/LIFE SUCCESS	1730-1900	TR	ACOMA	TBA	Simpson Rachelle
29641	COLL 101	G04	MS1 3	COLLEGE/LIFE SUCCESS	WEB	WEB	WEB	WEB	Brown Juana
29052	COLL 108	G01	MS2 3	ACAD RDG/STUDY SKILLS	1730-1900	TR	ACOMA	TBA	Simpson Rachelle
29428	COLL 108	G02	MS1 3	ACAD RDG/STUDY SKILLS	1400-1645	F	T	TBA	Secatero Shawn
29642	COLL 108	G03	3	ACAD RDG/STUDY SKILLS	1445-1600	MW	GRGQ	107	Alane Linda
28925	COLL 112	G01	3	ACAD SKILLS GEN	1600-1720	WR	GRGQ	110	Rael Rolando
29128	COLL 155	G01	2	LEADERSHIP DEVELOPMENT	WEB	WEB	WEB	WEB	Johnson Brian
					0830-0945	W	GRGQ	112	Johnson Brian
29462	COLL 155	G02	MS2 3	CRITICAL THINKING AND	1400-1645	F	TOHAJILLEE		Secatero Shawn

COMM-COMMUNICATION

28737	COMM 253G	G01	3	PUBLIC SPEAKING	1700-1930	M	GRGQ	107	Burke Gail
28738	COMM 253G	G02	3	PUBLIC SPEAKING	1425-1540	TR	GRGQ	107	Savacheck Mary
28739	COMM 265G	G01	3	FRNCPLS-HUMAN CMNCTN	0830-0945	TR	GRGQ	101	Savacheck Mary

DANC-DANCE

29086	DANC 122	G01	MS2 1	INTRO TO LATIN SOCIAL	1630-1730	MW	GRGM	220	Romero Alfred
-------	----------	-----	-------	-----------------------	-----------	----	------	-----	---------------

DRFT-DRAFTING

22520	DRFT 114	G01	3	INTRO MECH/SLD MDLNG	1000-1145	MW	GRGQ	122	Gutierrez
29026	DRFT 143	G01	3	CIVIL DRAFTING	1520-1715	TR	GRGQ	122	TBA
22511	DRFT 276	G01	3	COMP RENDER/ANIMATION	0815-0945	TR	GRGQ	122	Gutierrez
22522	DRFT 290	G01	3	2D ANIMATOR	0815-0945	MW	GRGQ	122	Gutierrez

E S-ENVIRONMENTAL SCIENCE

28905	E S 110G	G01	4	INTRO ENVIRON SCI	WEB	WEB	WEB	WEB	Walsh Sharon
-------	----------	-----	---	-------------------	-----	-----	-----	-----	--------------

ECED-EARLY CHILDHOOD EDUCATION

28868	ECED 115	G01	3	CHLD GWTH, DEV & LRNG	1730-1900	R	GRGQ	105	Ligon Karen
28869	ECED 125	G01	MS1 2	HEALTH, SAFETY & NUTR	WEB	WEB	WEB	WEB	O'Connor
22015	ECED 225	G01	3	CURR DEV & IMPL	WEB	WEB	WEB	WEB	Zamora J'Lane
22016	ECED 230	G01	2	ECED PRACTICUM II	WEB	WEB	WEB	WEB	Zamora J'Lane
22018	ECED 235	G01	3	INTRO LANG, LIT, RDG	1730-1900	MW	GRGN	301	O'Connor
22915	ECED 245	G02	MS2 2	PROFESSIONALISM	WEB	WEB	WEB	WEB	O'Connor
22023	ECED 255	G01	3	ASMNT OF CHLDRN/EVAL	WEB	WEB	WEB	WEB	Bell Kerri
22027	ECED 265	G01	3	GUIDING YOUNG CHILDREN	WEB	WEB	WEB	WEB	Ligon Karen

EDUC-EDUCATION

28870	EDUC 181	G01	MS1 1	FIELD EXPERIENCE I	WEB	WEB	WEB	WEB	O'Connor
28873	EDUC 195	G01	1	ECED PORTOFOLIO	1800-2000	M	GRGN	304	TBA
29371	EDUC 195	G02	3	ISSUES IN INDIAN EDUC	TBA	TBA	TOHAJILLEE		Secatero Shawn
28871	EDUC 204	G01	3	FNDTNS OF BIL/ESL ED	WEB	WEB	WEB	WEB	Riley Melissa
28872	EDUC 219	G01	3	PRE-TEACHER PREP	TBA	TBA			TBA

ELT - ELECTRONICS TECHNOLOGY

28848	ELT 110	G01	4	ELECTRONICS I	0900-1130	TR	GRGQ	050A	Epler John
28849	ELT 110	G02	4	ELECTRONICS I	1130-1400	MTWRF	GRGQ	050A	TBA
28850	ELT 160	G01	4	DIGITAL ELCTRNCS I	1430-1610	TRF	GRGQ	050A	TBA
28851	ELT 205	G01	4	SEMICONDUCTOR DEVICES	0900-1130	MW	GRGQ	050A	TBA
28852	ELT 221	G01	1	COOPERATIVE EXPR I	1000-1115	F	GRGQ	050A	TBA

EMD-EDUCATIONAL MGT/DVLPMT

22050	EMD 101	G01	1	FRESHMAN ORIENTATION	WEB	WEB	WEB	WEB	Morris Rex
22051	EMD 250	G01	2	INTRDN TO EDUCATION	WEB	WEB	WEB	WEB	Morris Rex

ENGL-ENGLISH

28725	ENGL 111G	G01	4	RHETORIC/COMPOSITION	1000-1140	TR	GRGQ	123	Gleason Irving
28726	ENGL 111G	G02	4	RHETORIC/COMPOSITION	1800-1940	TR	GRGQ	123	Humphreys
28727	ENGL 111G	G03	4	RHETORIC/COMPOSITION	1100-1240	MW	GRGQ	123	Humphreys
28728	ENGL 111G	G04	4	RHETORIC/COMPOSITION	0910-1200	S	GRGQ	101	Erben Joan
28729	ENGL 111G	G05	4	RHETORIC/COMPOSITION	1715-1855	MW	GRGQ	123	Gleason Irving
28730	ENGL 112	G01	MS1 2	RHETORIC & COMPOSITION	WEB	WEB	WEB	WEB	Humphreys
28732	ENGL 211G	G01	3	WRNG HMNTS/SOC SCIEN	1500-1615	TR	GRGQ	101	Humphreys
28733	ENGL 211G	G02	3	WRNG HMNTS/SOC SCIEN	1700-1930	M	GRGQ	101	Humphreys
28731	ENGL 218G	G01	3	TCNCL & SCNTFC CMNCTN	1715-1830	TR	GRGQ	101	Erben Joan

ENGR-ENGINEERING

28910	ENGR 111	G01	3	MATLAB	WEB	WEB	WEB	WEB	Hebert Jonathan
-------	----------	-----	---	--------	-----	-----	-----	-----	-----------------

FIN-FINANCE

22204	FIN 210	G01	3	FINCL PLANNING/INVSMT	WEB	WEB	WEB	WEB	Habiger Betty
-------	---------	-----	---	-----------------------	-----	-----	-----	-----	---------------

FREN-FRENCH

22270	FREN 112	G01	4	ELEMENTARY FRENCH II	1600-1900	F	GRGQ	102	Spencer Lynda
-------	----------	-----	---	----------------------	-----------	---	------	-----	---------------

GEOG-GEOGRAPHY

28906	GEOG 111G	G01	4	GEOG NATURAL ENVIR	1300-1420	MW	GRGQ	112	Walsh Sharon
					1400-1640	R	GRGQ	112	
28907	GEOG 259	G01	4	INTRO OCEANOGRAPHY	WEB	WEB	WEB	WEB	Leach Michael

GOVT-GOVERNMENT

29032	GOVT 100G	G01	3	AMER NATIONAL GOVT	1730-2030	R	GRGQ	107	McGaghie Thomas
29033	GOVT 100G	G02	3	AMER NATIONAL GOVT	WEB	WEB	WEB	WEB	Serban William

HIST-HISTORY

29087	HIST 102G	G01	3	MODERN EUROPE	WEB	WEB	WEB	WEB	Serban William
29088	HIST 201G	G01	3	INTRN-EARLY AMER HIST	0830-0945	MW	GRGQ	102	Webb Donn
29089	HIST 202G	G01	3	INTR-RECENT AMER HIST	0955-1110	MW	GRGQ	102	Webb Donn
29090	HIST 202G	G02	3	INTR-RECENT AMER HIST	1730-1945	T	GRGQ	102	TBA
22274	HIST 261	G01	3	NEW MEXICO HISTORY	WEB	WEB	WEB	WEB	Serban William

HNDS-HUMAN NUTRITION & DIET

28768	HNDS 251	G01	3	HUMAN NUTRITION	1600-1715	TR	GRGN	309	Broach Nancy
29164	HNDS 251	G02	3	HUMAN NUTRITION	WEB	WEB	WEB	WEB	Dixon Constance
29165	HNDS 251	G03	MS2 3	HUMAN NUTRITION	WEB	WEB	WEB	WEB	Dixon Constance

MATH-MATHEMATICS

28888	MATH 112G	G01	3	FUND ELEM MATH II	WEB	WEB	WEB	WEB	Chavez-Toivanen
					1630-1830	W	GRGQ	124	Chavez-Toivanen
28889	MATH 120	G01	3	INTERMEDIATE ALGEBRA (L)	1535-1705	MW	GRGQ	123	TBA
28890	MATH 120	G02	3	INTERMEDIATE ALGEBRA (L)	1700-1830	TR	GRGQ	124	Lowther Mark
28891	MATH 120	G03	3	INTERMEDIATE ALGEBRA	WEB	WEB	WEB	WEB	Chavez-Toivanen
28892	MATH 121G	G01	3	COLLEGE ALGEBRA	0955-1135	TR	GRGQ	102	TBA
28893	MATH 121G	G02	3	COLLEGE ALGEBRA	WEB	WEB	WEB	WEB	Mac Kendrick
28894	MATH 142G	G01	3	BUS/BIOI CALCULUS I	1230-1410	TR	GRGQ	102	TBA
29293	MATH 190G	G01	4	TRIG AND PRE-CALCULUS	WEB	WEB	WEB	WEB	TBA
28896	MATH 191G	G01	4	CALCULUS I	1615-1745	MWF	GRGQ	111	Hebert Jonathan
28895	MATH 210G	G01	3	MATH APPRECIATION	WEB	WEB	WEB	WEB	Mac Kendrick
					1600-1800	M	GRGQ	124	Mac Kendrick

MGT-MANAGEMENT

28913	MGT 201	G01	3	INTRDN TO MANAGEMENT	WEB	WEB	WEB	WEB	Grant Robbie
-------	---------	-----	---	----------------------	-----	-----	-----	-----	--------------

NA - NURSING ASSISTANT

29533	NA 104	G01	4	CRTFD NURS ASST FUND	WEB	WEB	WEB	WEB	Gallagher Neal
22371	NA 105	G01	4	CRTFD NURS ASST CLIN	WEB	WEB	WEB	WEB	Gallagher Neal
22379	NA 105	G02	4	CRTFD NURS ASST CLIN	WEB	WEB	WEB	WEB	Chachere Pamela

NAV-NAVAJO

29091	NAV 111	G01	4	ELEM NAVAJO I	WEB	WEB	WEB	WEB	Gleason Irving
					1300-1440	MW	GRGQ	103	Gleason Irving
29092	NAV 112	G01	4	ELEM NAVAJO II	WEB	WEB	WEB	WEB	Gleason Irving
					1450-1605	MW	GRGQ	103	Gleason Irving

OECS-COMPUTER TECHNOLOGY

28470	OECS 101	G01	MS1 1	COMPUTER BASICS	1900-2000	TR	GRGN	307	Prieto Marcos
27950	OECS 101	G02	MS2 1	COMPUTER BASICS	1900-2000	TR	GRGN	307	Prieto Marcos
29417	OECS 101	G03	MS1 1	COMPUTER BASICS	TBA	TBA	ACOMA	TBA	Simpson Rachelle
29419	OECS 101	G04	MS2 1	COMPUTER BASICS	TBA	TBA	ACOMA	TBA	Simpson Rachelle
29422	OECS 101	G05	MS1 1	COMPUTER BASICS	TBA	TBA	TOHAJILLEE	TBA	Begay Marcella
29425	OECS 101	G06	MS2 1	COMPUTER BASICS	TBA	TBA	TOHAJILLEE	TBA	Begay Marcella
29057	OECS 125	G01	3	OPERATING SYSTEMS	WEB	WEB	WEB	WEB	TBA
28860	OECS 185	G01	3	PC MAINT/SELECTION I	1715-1945	TR	GRGN	303	Henry Karen
28861	OECS 230	G01	MS1 3	DATA CMNCTN/NTWRKS I	WEB	WEB	WEB	WEB	Henry Karen
					1715-1945	MW	GRGN	303	Henry Karen
28862	OECS 231	G01	MS2 3	DATA CMNCTNS/NTWRK II	WEB	WEB	WEB	WEB	Henry Karen
					1715-1945	MW	GRGN	303	Henry Karen

OEEM- PARAMEDIC

29097	OEEM 101	G01	SC 1	CPR HEALTH CARE	0900-1600	S	GRGM	200	Chavez Brian
29098	OEEM 101	G02	SC 1	CPR HEALTH CARE	0900-1600	S	GRGM	200	Chavez Brian
22541	OEEM 120	G01	6	EMT-BASIC	1600-1800	F	GRGN	309	Desoto Tomasita

22545	OEEM 120 L	G01	2	EMT-BASIC LAB	0800-1300	S	GRGN	309	
22546	OEEM 121	G01	MS2 1	EMT-B FIELD/CLINICAL	1300-1800	S	GRGN	309	Desoto Tomasita
					TBA	TBA	TBA	TBA	Desoto Tomasita
OEET- ELECTRICAL TRADES									
28853	OEET 110	G01	4	BSC ELCTRCTY/ELCTRNC	0900-1130	TR	GRGQ	050D	TBA
28854	OEET 115	G01	5	WIRING MTHDS & MTRLS	1645-2000	TR	GRGQ	050D	TBA
28855	OEET 205	G01	3	NATIONAL ELCTRC CODE	WEB	WEB	WEB	WEB	TBA
28856	OEET 210	G01	5	INTRMD ELECTRICITY	1430-1730	MW	GRGQ	050D	TBA
28857	OEET 221	G01	1	COOP EXPERIENCE I	1300-1530	F	GRGQ	050D	TBA
P E-PHYSICAL EDUCATION									
25039	P E 270	G05	MS1 1	ZUMBA FITNESS	1200-1330	TR	GRGM	221	Almanza Crystal
25040	P E 270	G06	MS2 1	ZUMBA FITNESS	1200-1330	TR	GRGM	221	Almanza Crystal
PHIL-PHILOSOPHY									
29093	PHIL 201G	G01	3	INTRN TO PHILOSOPHY	1800-2030	M	GRGQ	003	Collins Randolph
PHYS-PHYSICS									
28908	PHYS 215G	G01	3	ENGINEERING PHYS I	TBA	TBA	TBA	TBA	Hebert Jonathan
PSY-PSYCHOLOGY									
22904	PSY 201G	G01	3	INTRDN-PSYCHOLOGY	WEB	WEB	WEB	WEB	Payette Bruce
22909	PSY 201G	G02	MS2 3	INTRDN-PSYCHOLOGY	WEB	WEB	WEB	WEB	Payette Bruce
29034	PSY 274	G01	3	SUBST ABUSE/SERV LRNG	WEB	WEB	WEB	WEB	Coats Melissa
S WK-SOCIAL WORK									
29037	S WK 221G	G01	3	INTRO SOCIAL WELFARE	WEB	WEB	WEB	WEB	Coats Melissa
SOC-SOCIOLOGY									
29035	SOC 101G	G01	3	INTRDRY SOCIOLOGY	0955-1110	MW	GRGQ	112	Vigil Mary
29036	SOC 201G	G01	3	CNTRPRY SOCIAL PRMS	1230-1345	MW	GRGQ	107	Vigil Mary
SPAN-SPANISH									
29095	SPAN 111	G01	4	ELEMENTARY SPANISH I	1600-1740	TR	GRGQ	103	Chavez Orieta
29096	SPAN 112	G01	4	ELEMENTARY SPANISH II	1755-1935	TR	GRGQ	103	Chavez Orieta
THTR-THEATRE									
28734	THTR 101G	G01	3	WORLD OF THEATRE	1715-1930	W	GRGQ	101	Erben Joan
W S-WOMEN'S STUDIES									
29038	W S 202G	G01	3	REP WOMEN ACROSS CULT	WEB	WEB	WEB	WEB	Coats Melissa
WELD-WELDING TECHNOLOGY									
22532	WELD 115	G01	6	STRCTRL WELDING II	1300-1700	TR	GRGQ	051A	Sandoval Alex
29028	WELD 120	G01	3	BASIC METALLURGY	WEB	WEB	WEB	WEB	Gutierrez
22530	WELD 130	G01	3	INTRO TO GMAW (MIG)	1700-1845	MW	GRGQ	051	Sandoval Alex
22531	WELD 140	G01	3	INTRO TO GTAW (TIG)	1900-2045	MW	GRGQ	051	Gutierrez
22534	WELD 211	G01	6	WELDER QUALIFICATION	1300-1700	TR	GRGQ	051	Gutierrez
22535	WELD 295	G01	3	METAL ART II	1900-2045	MW	GRGQ	051A	TBA
22537	WELD 295	G02	1	SKILLS USA	0800-0945	F	GRGQ	050	Gutierrez

8 Week I January 17 to March 12

28865	C EP 110G	G03	MS1 3	HUMAN GROWTH/BEHAVIOR	WEB	WEB	WEB	WEB	O'Connor
28875	CCDM 100 N	G02	MS1 4	MATH PREP COLLEGE	1300-1510	MTWR	GRGQ	123	Lyons Connie
28881	CCDM 112 N	G01	MS1 4	DVLPMTNL ALGEBRA I	0955-1210	MTWR	GRGQ	124	Lyons Connie
29356	CMT 190	G01	MS1 3	DIG VID PROD I	1000-1700	S	GRGN	301	TBA
29050	COLL 101	G01	MS1 3	COLLEGE/LIFE SUCCESS	1730-1900	TR	ACOMA	TBA	Simpson Rachelle
29641	COLL 101	G04	MS1 3	COLLEGE/LIFE SUCCESS	WEB	WEB	WEB	WEB	Brown Juana
29428	COLL 108	G02	MS1 3	ACAD RDG/STUDY SKILLS	1400-1645	F	T	TBA	Secatero Shawn
28869	ECED 125	G01	MS1 2	HEALTH, SAFETY & NUTR	WEB	WEB	WEB	WEB	O'Connor
28870	EDUC 181	G01	MS1 1	FIELD EXPERIENCE I	WEB	WEB	WEB	WEB	O'Connor
28730	ENGL 112	G01	MS1 2	RHETORIC & COMPOSITION	WEB	WEB	WEB	WEB	Humphreys
28470	OECS 101	G01	MS1 1	COMPUTER BASICS	1900-2000	TR	GRGN	307	Prieto Marcos
29417	OECS 101	G03	MS1 1	COMPUTER BASICS	TBA	TBA	ACOMA	TBA	Simpson Rachelle
29422	OECS 101	G05	MS1 1	COMPUTER BASICS	TBA	TBA	TOHAJILLEE		Begay Marcella
28861	OECS 230	G01	MS1 3	DATA CMNCTN/NTWRKS I	WEB	WEB	WEB	WEB	Henry Karen
					1715-1945	MW	GRGN	303	Henry Karen
25039	P E 270	G05	MS1 1	ZUMBA FITNESS	1200-1330	TR	GRGM	221	Almanza Crystal

8 Week II March 13 to May 10

28866	C EP 210	G01	MS2 3	EDUCATIONAL PSY	WEB	WEB	WEB	WEB	O'Connor
28858	C S 110	G04	MS2 3	COMPUTER LITERACY	WEB	WEB	WEB	WEB	Prieto Marcos
28880	CCDM 103 N	G05	MS2 4	PREALGEBRA	1300-1510	MTWR	GRGQ	123	Lyons Connie
28882	CCDM 113 N	G01	MS2 4	DVLPMTNL ALGEBRA II	0955-1210	MTWR	GRGQ	124	Lyons Connie
29052	COLL 108	G01	MS2 3	ACAD RDG/STUDY SKILLS	1730-1900	TR	ACOMA	TBA	Simpson Rachelle
29462	COLL 155	G02	MS2 3	CRITICAL THINKING AND	1400-1645	F	TOHAJILLEE		Secatero Shawn
29086	DANC 122	G01	MS2 1	INTRO TO LATIN SOCIAL	1630-1730	MW	GRGM	220	Romero Alfred
22915	ECED 245	G02	MS2 2	PROFESSIONALISM	WEB	WEB	WEB	WEB	O'Connor
29165	HNSD 251	G03	MS2 3	HUMAN NUTRITION	WEB	WEB	WEB	WEB	Dixon Constance
27950	OECS 101	G02	MS2 1	COMPUTER BASICS	1900-2000	TR	GRGN	307	Prieto Marcos

29419	OECS 101	G04	MS2	1	COMPUTER BASICS	TBA	TBA	ACOMA	TBA	Simpson Rachelle
29425	OECS 101	G06	MS2	1	COMPUTER BASICS	TBA	TBA	TOHAJIILEE	TBA	Begay Marcella
28862	OECS 231	G01	MS2	3	DATA CMNCTNS/NTWRK II	WEB	WEB	WEB	WEB	Henry Karen
						1715-1945	MW	GRGN	303	Henry Karen
22546	OEEM 121	G01	MS2	1	EMT-B FIELD/CLINICAL	TBA	TBA	TBA	TBA	Desoto Tomasita
25040	P E 270	G06	MS2	1	ZUMBA FITNESS	1200-1330	TR	GRGM	221	Almanza Crystal
22909	PSY 201G	G02	MS2	3	INTRDN-PSYCHOLOGY	WEB	WEB	WEB	WEB	Payette Bruce

Web-Assisted (Hybrid)

28901	BIOL 226	G01		4	HUMAN ANATOMY/PHYS II	WEB	WEB	WEB	WEB	Walsh Sharon
						1500-1800	M	GRGQ	110	Walsh Sharon
29638	C EP 210	G03		3	EDUCATIONAL PSY	WEB	WEB	WEB	WEB	Stockdale
						1800-1900	MW	GRGN	302	Stockdale
28903	CHEM 110G	G01		4	PRINC & APPL OF CHEM	WEB	WEB	WEB	WEB	Rael Rolando
						1000-1300	T	GRGQ	110	Rael Rolando
29128	COLL 155	G01		2	LEADERSHIP DEVELOPMENT	WEB	WEB	WEB	WEB	Johnson Brian
						0830-0945	W	GRGQ	112	Johnson Brian
28888	MATH 112G	G01		3	FUND ELEM MATH II	WEB	WEB	WEB	WEB	Chavez-Toivanen
						1630-1830	W	GRGQ	124	Chavez-Toivanen
28895	MATH 210G	G01		3	MATH APPRECIATION	WEB	WEB	WEB	WEB	Mac Kendrick
						1600-1800	M	GRGQ	124	Mac Kendrick
29091	NAV 111	G01		4	ELEM NAVAJO I	WEB	WEB	WEB	WEB	Gleason Irving
						1300-1440	MW	GRGQ	103	Gleason Irving
29092	NAV 112	G01		4	ELEM NAVAJO II	WEB	WEB	WEB	WEB	Gleason Irving
						1450-1605	MW	GRGQ	103	Gleason Irving
28861	OECS 230	G01	MS1	3	DATA CMNCTN/NTWRKS I	WEB	WEB	WEB	WEB	Henry Karen
						1715-1945	MW	GRGN	303	Henry Karen
28862	OECS 231	G01	MS2	3	DATA CMNCTNS/NTWRK II	WEB	WEB	WEB	WEB	Henry Karen
						1715-1945	MW	GRGN	303	Henry Karen
29028	WELD 120	G01		3	BASIC METALLURGY	WEB	WEB	WEB	WEB	Gutierrez
						1700-1845	MW	GRGQ	050	Gutierrez

Web-Based

22170	ACCT 251	G01		3	MANAGEMENT ACCOUNTING	WEB	WEB	WEB	WEB	Habiger Betty
22177	ACCT 252	G01		3	FINANCIAL ACCOUNTING	WEB	WEB	WEB	WEB	Habiger Betty
28715	AHS 120	G01		3	MEDICAL TERMINOLOGY	WEB	WEB	WEB	WEB	Gallagher Neal
28716	AHS 153	G01		4	INTRO ANTMY/PHYSLGY I	WEB	WEB	WEB	WEB	Gallagher Neal
22195	BLAW 230	G01		3	BUSINESS LAW	WEB	WEB	WEB	WEB	TBA
28912	BMGT 216	G01		3	BUSINESS MATH	WEB	WEB	WEB	WEB	Habiger Betty
28915	BMGT 221	G01		3	CO-OP EXPERIENCE I	WEB	WEB	WEB	WEB	Habiger Betty
28914	BMGT 240	G01		3	HUMAN RELATIONS	WEB	WEB	WEB	WEB	Habiger Betty
22000	C EP 110G	G01		3	HUMAN GROWTH/BEHAVIOR	WEB	WEB	WEB	WEB	Adams Kumen
28865	C EP 110G	G03	MS1	3	HUMAN GROWTH/BEHAVIOR	WEB	WEB	WEB	WEB	O'Connor
28866	C EP 210	G01	MS2	3	EDUCATIONAL PSY	WEB	WEB	WEB	WEB	O'Connor
22006	C EP 210	G02		3	EDUCATIONAL PSY	WEB	WEB	WEB	WEB	Adams Kumen
22720	C J 101G	G01		3	INTRO CRIMINAL JUSTICE	WEB	WEB	WEB	WEB	Stoneking Megan
22727	C J 199	G01		3	CRIMINOLOGY THEORIES	WEB	WEB	WEB	WEB	Faught-Hollar
22730	C J 199	G02		3	ELDER LAW	WEB	WEB	WEB	WEB	Faught-Hollar
22731	C J 199	G03		3	HUMAN TRAFFICKING	WEB	WEB	WEB	WEB	Stoneking Megan
22732	C J 205	G01		3	CRIMINAL LAW I	WEB	WEB	WEB	WEB	Lucero Gloria
22858	C J 210	G01		3	AMER LAW ENFRCTM SYTM	WEB	WEB	WEB	WEB	Lucero Roshanna
22859	C J 230	G01		3	INTRN TO CORRECTIONS	WEB	WEB	WEB	WEB	Lucero Roshanna
22860	C J 250	G01		3	COURTS/CRMNL JUST SYT	WEB	WEB	WEB	WEB	TBA
28651	C S 110	G03		3	COMPUTER LITERACY	WEB	WEB	WEB	WEB	Gallegos Gabriel
28858	C S 110	G04	MS2	3	COMPUTER LITERACY	WEB	WEB	WEB	WEB	Prieto Marcos
28859	C S 209	G01		3	NETWORK ADMINISTRATION	WEB	WEB	WEB	WEB	TBA
22575	CMT 130	G01		3	WEB DESIGN I	WEB	WEB	WEB	WEB	Mann Thomas
28905	E S 110G	G01		4	INTRO ENVIRON SCI	WEB	WEB	WEB	WEB	Walsh Sharon
28869	ECED 125	G01	MS1	2	HEALTH, SAFETY & NUTR	WEB	WEB	WEB	WEB	O'Connor
22015	ECED 225	G01		3	CURR DEV & IMPL	WEB	WEB	WEB	WEB	Zamora J'Lane
22016	ECED 230	G01		2	ECED PRACTICUM II	WEB	WEB	WEB	WEB	Zamora J'Lane
22915	ECED 245	G02	MS2	2	PROFESSIONALISM	WEB	WEB	WEB	WEB	O'Connor
22023	ECED 255	G01		3	ASMNT OF CHLDRN/EVAL	WEB	WEB	WEB	WEB	Bell Kerri
22027	ECED 265	G01		3	GUIDING YOUNG CHILDREN	WEB	WEB	WEB	WEB	Ligon Karen
28870	EDUC 181	G01	MS1	1	FIELD EXPERIENCE I	WEB	WEB	WEB	WEB	O'Connor
28871	EDUC 204	G01		3	FNDTNS OF BIL/ESL ED	WEB	WEB	WEB	WEB	Riley Melissa
22050	EMD 101	G01		1	FRESHMAN ORIENTATION	WEB	WEB	WEB	WEB	Morris Rex
22051	EMD 250	G01		2	INTRDN TO EDUCATION	WEB	WEB	WEB	WEB	Morris Rex
28730	ENGL 112	G01	MS1	2	RHETORIC & COMPOSITION	WEB	WEB	WEB	WEB	Humphreys
28910	ENGR 111	G01		3	MATLAB	WEB	WEB	WEB	WEB	Hebert Jonathan
22204	FIN 210	G01		3	FINCL PLANNING/INVSMT	WEB	WEB	WEB	WEB	Habiger Betty
28907	GEOG 259	G01		4	INTRO OCEANOGRAPHY	WEB	WEB	WEB	WEB	Leach Michael
29033	GOVT 100G	G02		3	AMER NATIONAL GOVT	WEB	WEB	WEB	WEB	Serban William
29087	HIST 102G	G01		3	MODERN EUROPE	WEB	WEB	WEB	WEB	Serban William
22274	HIST 261	G01		3	NEW MEXICO HISTORY	WEB	WEB	WEB	WEB	Serban William
29164	HNDS 251	G02		3	HUMAN NUTRITION	WEB	WEB	WEB	WEB	Dixon Constance
29165	HNDS 251	G03	MS2	3	HUMAN NUTRITION	WEB	WEB	WEB	WEB	Dixon Constance
28891	MATH 120	G03		3	INTERMEDIATE ALGEBRA	WEB	WEB	WEB	WEB	Chavez-Toivanen
28893	MATH 121G	G02		3	COLLEGE ALGEBRA	WEB	WEB	WEB	WEB	Mac Kendrick
29293	MATH 190G	G01		4	TRIG AND PRE-CALCULUS	WEB	WEB	WEB	WEB	TBA
28913	MGT 201	G01		3	INTRDN TO MANAGEMENT	WEB	WEB	WEB	WEB	Grant Robbie
29533	NA 104	G01		4	CRTFD NURS ASST FUND	WEB	WEB	WEB	WEB	Gallagher Neal
22371	NA 105	G01		4	CRTFD NURS ASST CLIN	WEB	WEB	WEB	WEB	Gallagher Neal
22379	NA 105	G02		4	CRTFD NURS ASST CLIN	WEB	WEB	WEB	WEB	Chachere Pamela
29057	OECS 125	G01		3	OPERATING SYSTEMS	WEB	WEB	WEB	WEB	TBA
22904	PSY 201G	G01		3	INTRDN-PSYCHOLOGY	WEB	WEB	WEB	WEB	Payette Bruce
22909	PSY 201G	G02	MS2	3	INTRDN-PSYCHOLOGY	WEB	WEB	WEB	WEB	Payette Bruce
29034	PSY 274	G01		3	SUBST ABUSE/SERV LRNG	WEB	WEB	WEB	WEB	Coats Melissa
29037	S WK 221G	G01		3	INTRO SOCIAL WELFARE	WEB	WEB	WEB	WEB	Coats Melissa
29038	W S 202G	G01		3	REP WOMEN ACROSS CULT	WEB	WEB	WEB	WEB	Coats Melissa

Corrections Officer Training Academy COTA

Corrections courses run concurrently and students must register for all four courses. The lab fee for each course is \$135.00. Contact Michael Richer at 287-6670 or at mdricher@nmsu.edu for more information.

OEPS-PUBLIC SAFETY

29126	OEPS 250	G01	SC	4	CORRCT OFFICER TRNG	0800-1600	MTWRF	GRGM	200	Richer Michael
29127	OEPS 280	G01	SC	4	CORRCT OFFICER TRNG IV	0800-1600	MTWRF	GRGM	200	Richer Michael

